

NOTES: UNLESS OTHERWISE SPECIFIED
THIS IS A CAD GENERATED DRAWING, DO NOT REVISE MANUALLY

REVISION HISTORY					
ZONE	REV	DESCRIPTION	E.C.O.NO	DATE	APPROVED
	1	ENGINEERING RELEASE			

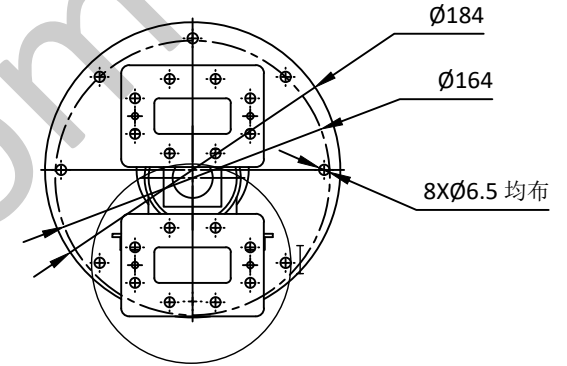
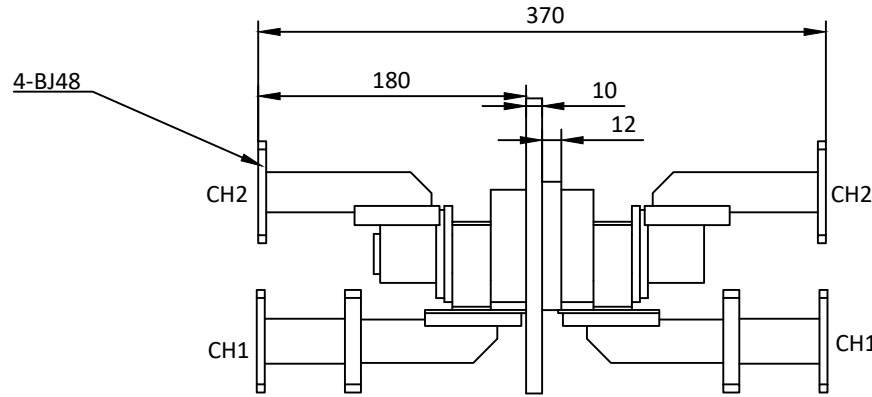

LRJ-1052

双通道旋转关节 Dual Channel Rotary Joint
—电气技术参数 Electrical Specifications—

通道 Channel:	CH1	CH2
工作频率 Frequency Range:	5.4 - 5.9GHz	5.4 - 5.9GHz
插入损耗 Insertion Loss:	0.5dB(Max)	0.5dB(Max)
插入损耗最大波动值:	0.1dB	0.1dB
电压驻波比 VSWR:	1.3(Max)	1.3(Max)
驻波比最大波动值:	0.05	0.1
耐功率 Power:	35kW(CW) 350kW(Peak)	5kW(CW) 50kW(Peak)
工作温度 Operation Temperature:	-40~+70°C	
存储温度 Storage Temperature:	/	
转动速度 Speed:	60rpm(Max)	
寿命 Life:	5*10 ⁶ 转(Min)	

—机械技术参数 Mechanical Specification—

接口 Connectors: BJ48
样式 Type: /
重量 Weight: /

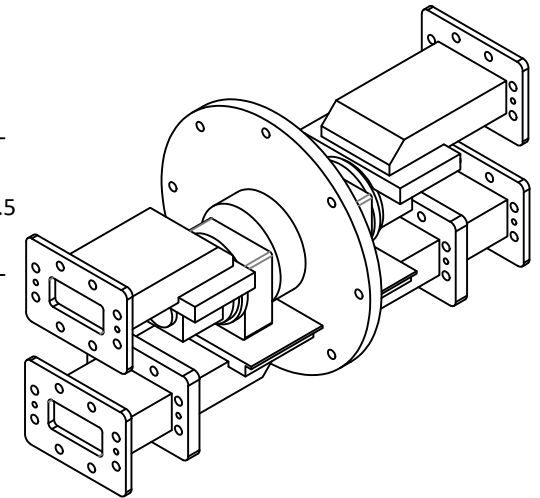
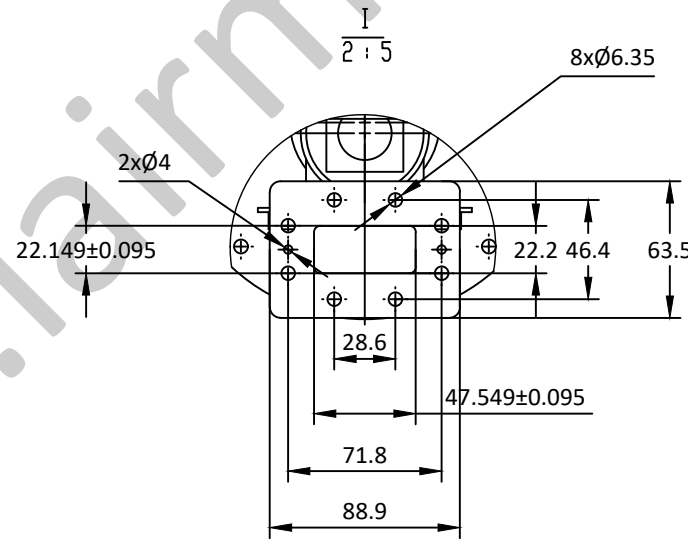

UNLESS OTHERWISE SPECIFIED
DIMENSIONS ARE MILLIMETER
TOLERANCES ARE:
DECIMALS ANGLES FRACTIONS
.XX±0.1 ±1' ±2/5
.XXX±0.03
.XXX±0.012

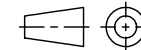

Approvals

DATE

DRWN

ENG

CHK

Q.A.



www.lairmw.com sales@lairmw.com

P/N: LRJ-1052

DUAL CHANNEL COAX ROTARY JOINT
双通道同轴旋转关节

SIZE	CAGE NO	DWG NO.	REV
A3			1
SCALE 3:2	UNIT mm	SHEET 1 OF 1	

HOLE DIAMETER	TOLERANCES
.35 TO 3.20	+.05/-0.2
3.21 TO 6.35	+.10/-0.3
6.36 TO 12.70	+.15/-0.3
12.71 TO 19.05	+.20/-0.3
19.06 TO 25.40	+.25/-0.3
25.41 TO 50.80	+.30/-0.3