

NOTES: UNLESS OTHERWISE SPECIFIED
THIS IS A CAD GENERATED DRAWING, DO NOT REVISE MANUALLY

REVISION HISTORY					
ZONE	REV	DESCRIPTION	E.C.O.NO	DATE	APPROVED
	1	ENGINEERING RELEASE			

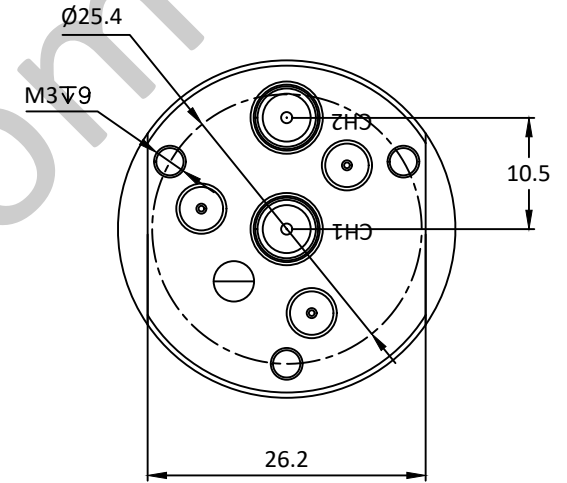
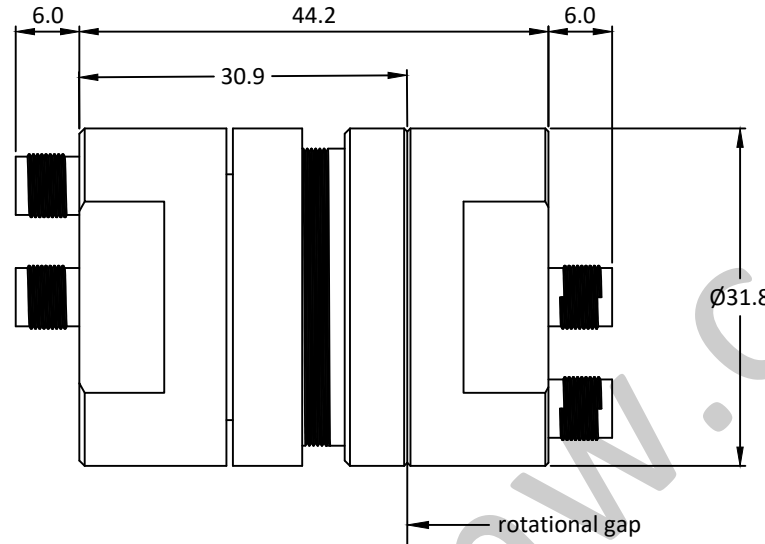
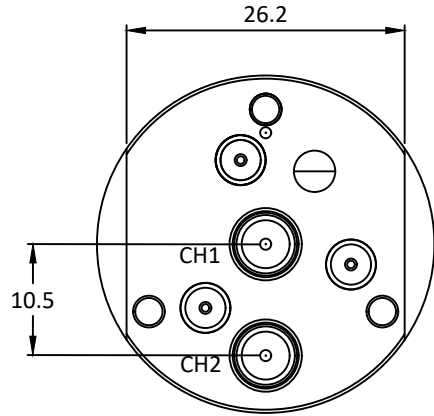

LRJ-1017

双通道旋转关节 Dual Channel Rotary Joint

—电气技术参数 Electrical Specifications—

通道 Channel:	CH1	CH2
工作频率 Frequency Range:	DC - 5GHz	DC - 4.5GHz
插入损耗 Insertion Loss:	0.3dB(Max)	0.5dB(Max)
插入损耗最大波动值:	0.05dB	0.15dB
电压驻波比 VSWR:	1.2(Max)	1.5(Max)
驻波比最大波动值:	0.05	0.2
耐功率 Power:	100W@DC-2GHz/60W@2-4.5GHz(CW)	10W(CW)
	1kW(Peak)	1kW(Peak)
工作温度 Operation Temperature:	-40~+55°C	
存储温度 Storage Temperature:	-40~+65°C	
转动速度 Speed:	30rpm(Max)	
寿命 Life:	5*10 ⁶ 转(Min)	

—机械技术参数 Mechanical Specification—

接口 Connectors:	SMA-F
样式 Type:	I
重量 Weight:	130g

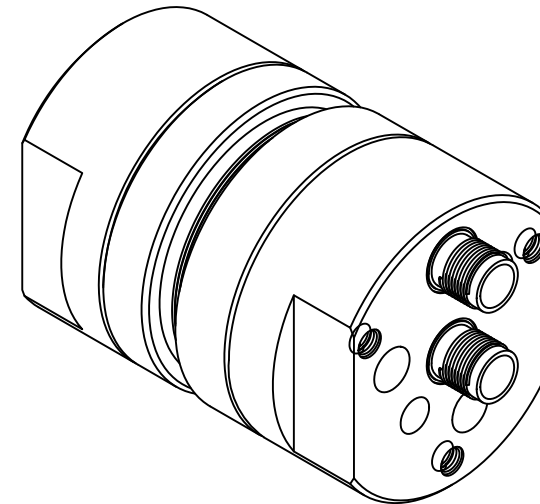

UNLESS OTHERWISE SPECIFIED DIMENSIONS ARE MILLIMETER TOLERANCES ARE: DECIMALS ANGLES FRACTIONS .XX±0.1 ±1' ±2/5 .XXX±0.012				莱尔微波 www.lairmw.com sales@lairmw.com		P/N: LRJ-1017																									
<table border="1"> <thead> <tr> <th>HOLE DIAMETER</th> <th>TOLERANCES</th> </tr> </thead> <tbody> <tr> <td>.35 TO 3.20</td> <td>+05/-02</td> </tr> <tr> <td>3.21 TO 6.35</td> <td>+10/-03</td> </tr> <tr> <td>6.36 TO 12.70</td> <td>+15/-03</td> </tr> <tr> <td>12.71 TO 19.05</td> <td>+20/-03</td> </tr> <tr> <td>19.06 TO 25.40</td> <td>+25/-03</td> </tr> <tr> <td>25.41 TO 50.80</td> <td>+30/-03</td> </tr> </tbody> </table>		HOLE DIAMETER	TOLERANCES	.35 TO 3.20	+05/-02	3.21 TO 6.35	+10/-03	6.36 TO 12.70	+15/-03	12.71 TO 19.05	+20/-03	19.06 TO 25.40	+25/-03	25.41 TO 50.80	+30/-03	<table border="1"> <thead> <tr> <th>DRWN</th> <th>DATE</th> </tr> </thead> <tbody> <tr> <td> </td> <td> </td> </tr> <tr> <th>ENG</th> <td> </td> </tr> <tr> <th>CHK</th> <td> </td> </tr> <tr> <th>Q.A.</th> <td> </td> </tr> </tbody> </table>		DRWN	DATE			ENG		CHK		Q.A.		DUAL CHANNEL COAX ROTARY JOINT 双通道同轴旋转关节			
HOLE DIAMETER	TOLERANCES																														
.35 TO 3.20	+05/-02																														
3.21 TO 6.35	+10/-03																														
6.36 TO 12.70	+15/-03																														
12.71 TO 19.05	+20/-03																														
19.06 TO 25.40	+25/-03																														
25.41 TO 50.80	+30/-03																														
DRWN	DATE																														
ENG																															
CHK																															
Q.A.																															
SIZE A3		CAGE NO		DWG NO.		REV 1																									
SCALE 3:2		UNIT mm		SHEET 1 OF 1																											