

NOTES: UNLESS OTHERWISE SPECIFIED
THIS IS A CAD GENERATED DRAWING, DO NOT REVISE MANUALLY

REVISION HISTORY					
ZONE	REV	DESCRIPTION	E.C.O.NO	DATE	APPROVED
	1	ENGINEERING RELEASE			

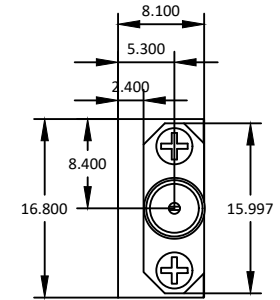
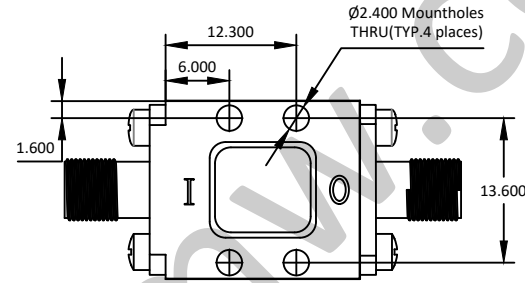
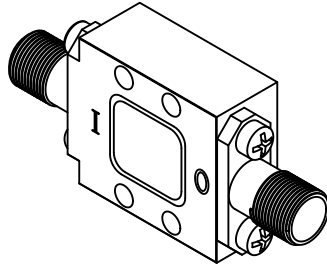

LPL-5001

1 - 800MHz 限幅器 RF Power Limiter

—电气技术参数 Electrical Specifications—

频率范围 Frequency Range:	1 - 800MHz
插入损耗 Insertion Loss:	0.1dB
P1dB限制阈值 P1dB Limiting Threshold:	+14dBm
输入IP3 Input IP3:	+32dBm
输入驻波比 Input VSWR:	1.2:1
输出驻波比 Output VSWR:	1.2:1
工作温度 Operation Temperature:	-40 ~ +85°C
存储温度 Storage Temperature:	-55 ~ +125°C

—机械技术参数 Mechanical Specification—

输入连接器 Input Interface:	SMA-F
输出连接器 Out Interface:	SMA-F
尺寸 Size (excluding connectors):	/
重量 Weight:	/

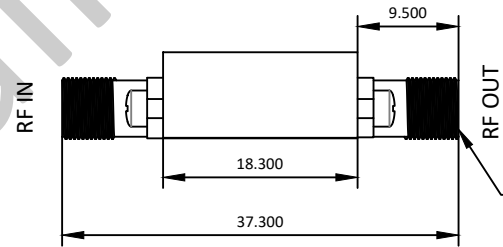

RF Connectors (2 PL.):
SMA-F, SuperSMA-F, or TypeK
(2.92mm/SMK)-F: According to
frequency (upto 18,26,40GHz)

UNLESS OTHERWISE SPECIFIED DIMENSIONS ARE MILLIMETER TOLERANCES ARE: DECIMALS ANGLES FRACTIONS .X±0.1 ±1° ±2/5 .XX±0.03 .XXX±0.012		莱尔微波 Laird Microwave www.lairmw.com sales@lairmw.com		P/N: LPL-5001	
		Approvals	DATE	1-800MHz 限幅器 RF Power Limiter	
HOLE DIAMETER .35 TO 3.20 3.21 TO 6.35 6.36 TO 12.70 12.71 TO 19.05 19.06 TO 25.40 25.41 TO 50.80	TOLERANCES +.05/-02 +.10/-03 +.15/-03 +.20/-03 +.25/-03 +.30/-03	DRWN	ENG	CHK	Q.A.
		SIZE	A3	CAGE NO	DWG NO.
		SCALE	3:2	UNIT	mm
				DWG NO.	REV
					1
		SHEET 1 OF 1			