

NOTES:UNLESSOTHERWISE SPECIFIED
THIS IS A CAD GENERATED DRAWING,DO NOT REVISE MANUALLY

REVISION HISTORY					
ZONE	REV	DESCRIPTION	E.C.O.NO	DATE	APPROVED
	1	ENGINEERING RELEASE			

LMA-3001

3 – 9 GHz 有源二倍频器 Active Frequency Doubler

—电气技术参数 Electrical Specifications—

输入频率范围 Input Frequency Range:	3 – 9GHz
输出频率范围 Output Frequency Range:	6 – 18GHz
输入功率 Input Power:	-3~+3dBm
输出功率 Output Power:	+20dBm (Typ.)
谐波抑制 Harmonic Suppression:	-15dBc
直流偏置电压 DC Power Supply:	+5V (Typ.)/+8V(Max.)
直流偏置电流 DC Current Supply:	250mA
工作温度 Operation Temperature:	-45 ~ +85°C
存储温度 Storage Temperature:	-55 ~ +125°C

—机械技术参数 Mechanical Specifications—

输入连接器 Input Interface:	SMA-F
输出连接器 Output Interface:	SMA-M
尺寸 Size (excluding connectors):	/
重量 Weight:	80g

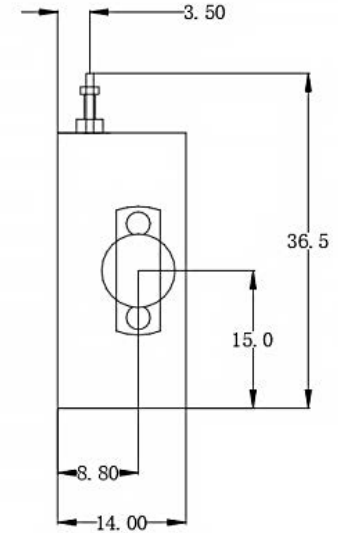
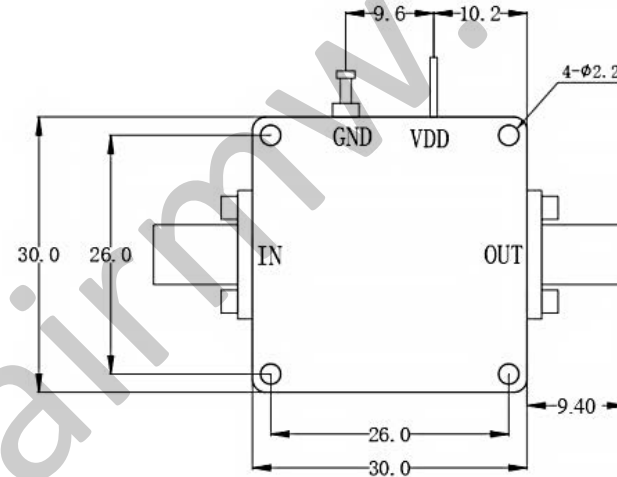

UNLESS OTHERWISE SPECIFIED DIMENSIONS ARE MILLIMETER TOLERANCES ARE: DECIMALS ANGLES FRACTIONS .XX±0.03 ±1' ±2/5 .XXX±0.012			莱尔微波 Laird Microwave www.lairmw.com sales@lairmw.com		P/N: LMA-3001	
			Approvals	DATE	3 – 9 GHz Active Frequency Doubler 有源二倍频器	
HOLE DIAMETER .35 TO 3.20 3.21 TO 6.35 6.36 TO 12.70 12.71 TO 19.05 19.06 TO 25.40 25.41 TO 50.80	TOLERANCES +.05/- .02 +.10/- .03 +.15/- .03 +.20/- .03 +.25/- .03 +.30/- .03	DRWN	SIZE A3		CAGE NO	DWG NO.
		ENG	SCALE 3:2		UNIT mm	REV 1
		CHK	SHEET 1 OF 1			
Q.A.						