

NOTES:UNLESS OTHERWISE SPECIFIED
THIS IS A CAD GENERATED DRAWING,DO NOT REVISE MANUALLY

REVISION HISTORY					
ZONE	REV	DESCRIPTION	E.C.O.NO	DATE	APPROVED
	1	ENGINEERING RELEASE			

Truth Table

TTL				J2	J3	J4	J5
C1	C2	C3	C4				
1	0	0	0	ON	OFF	OFF	OFF
0	1	0	0	OFF	ON	OFF	OFF
0	0	1	0	OFF	OFF	ON	OFF
0	0	0	1	OFF	OFF	OFF	ON

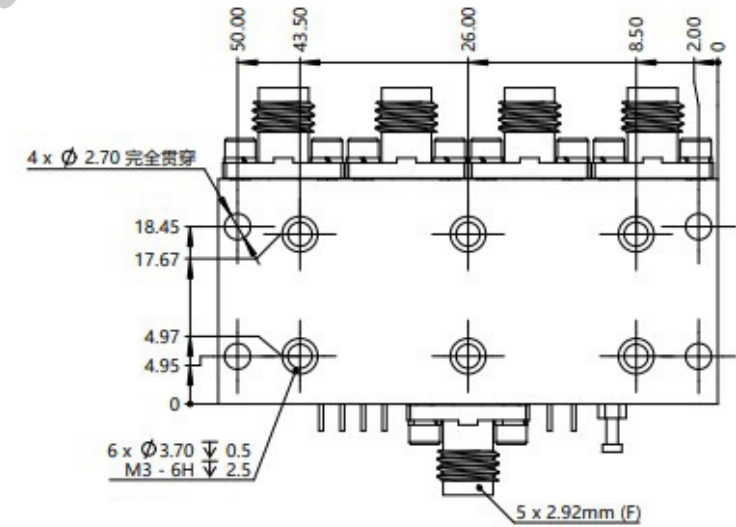
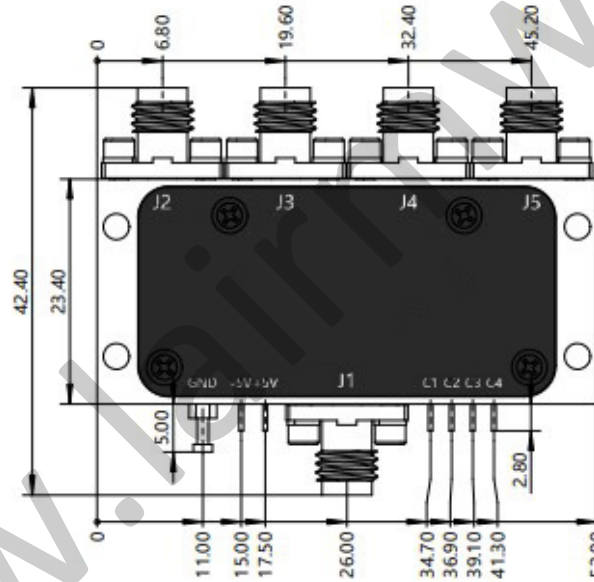
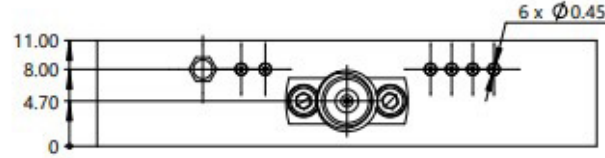
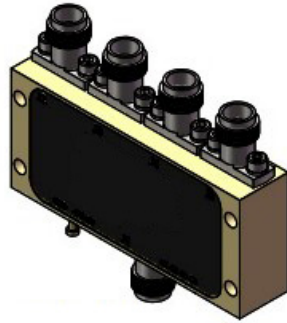

LES-2027

26.5 - 40GHz PIN反射式单刀四掷开关PIN Reflection SP4T Switch

—电气技术参数Electrical Specifications—

频率范围 Frequency Range:	26.5 - 40GHz
隔离度 Isolation:	60dB(Typ.)
插入损耗 Insertion Loss:	5.0-8.0dB
驻波 VSWR:	1.7:1(Typ.)
开关速度 Switching Speed:	100ns
最大输入功率 Maximum Input Power:	+23dBm
控制方式 Control Mode:	TTL(详见真值表)
直流偏置电压 DC Supply Voltage:	±5V
直流偏置电流 DC Supply Current:	60mA
工作温度 Operation Temperature:	-40 ~ +85°C
存储温度 Storage Temperature:	-65 ~ +125°C

—机械技术参数Mechanical Specification—

输入连接器 Input Interface:	2.92mm-F
输出连接器 Output Interface:	2.92mm-F
尺寸 Size(excluding connectors):	52x23.4x11mm
重量 Weight:	45g

UNLESS OTHERWISE SPECIFIED DIMENSIONS ARE MILLIMETER TOLERANCES ARE: DECIMALS ANGLES FRACTIONS .XX±0.03 ±1° ±2/5 .XXX±0.012				莱尔微波 www.lairmw.com sales@lairmw.com		P/N: LES-2027	
HOLE DIAMETER .35 TO 3.20 3.21 TO 6.35 6.36 TO 12.70 12.71 TO 19.05 19.06 TO 25.40 25.41 TO 50.80		TOLERANCES +.05/- .02 +.10/- .03 +.15/- .03 +.20/- .03 +.25/- .03 +.30/- .03		Approvals DATE		26.5-40GHz PIN反射式单刀四掷开关 PIN Reflection SP4T Switch	
DRWN	ENG	CHK	Q.A.	SIZE A3	CAGE NO	DWG NO.	REV 1
				SCALE 3:2	UNIT mm	SHEET 1 OF 1	