

NOTES: UNLESS OTHERWISE SPECIFIED
THIS IS A CAD GENERATED DRAWING, DO NOT REVISE MANUALLY

REVISION HISTORY					
ZONE	REV	DESCRIPTION	E.C.O.NO	DATE	APPROVED
	1	ENGINEERING RELEASE			

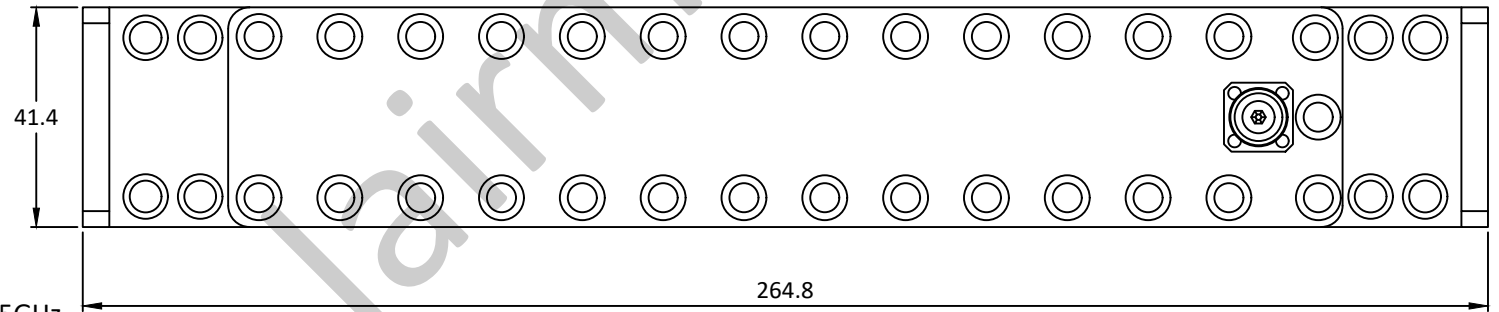
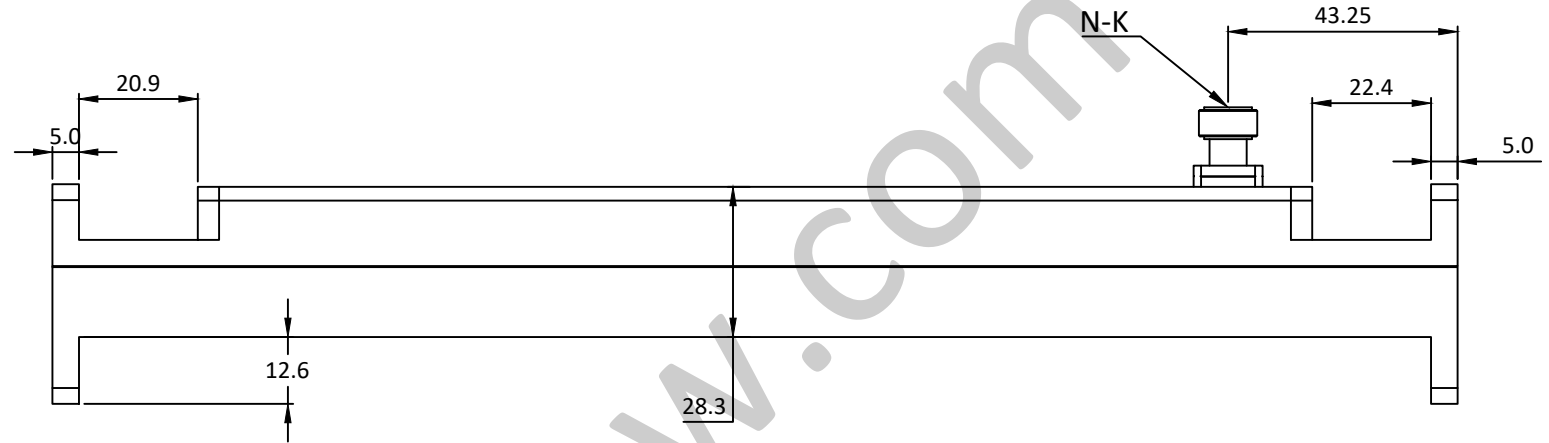
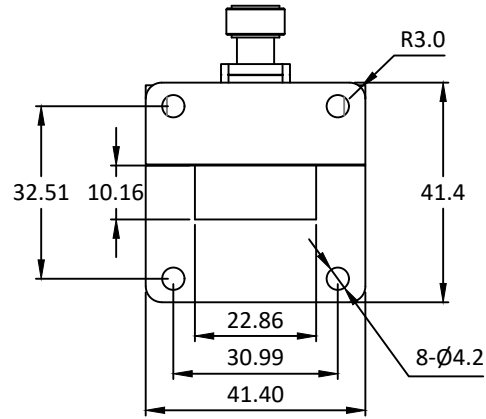

LBC-0001

8.2 - 12.5GHz 波导耦合器 Waveguide Coupler

—电气技术参数 Electrical Specifications—

工作频率 Frequency Range: 8.2 - 12.5GHz
 耦合度 Coupling: 30dB
 方向性 Directivity: ≥ 30 dB
 主路驻波 Primary VSWR: ≤ 1.1
 副路驻波 Secondary VSWR: ≤ 1.3
 平均功率 CW: 5kW
 工作温度 Operation Temperature: -40~+85 C

—机械技术参数 Mechanical Specification—

接口 Connectors: N-K
 法兰 Flange: FBP100

UNLESS OTHERWISE SPECIFIED DIMENSIONS ARE MILLIMETER TOLERANCES ARE: DECIMALS ANGLES FRACTIONS .XX±0.1 ±1' ±2/5 .XXX±0.03 .XXX±0.012						P/N: LBC-0001	
		Approvals		DATE		www.lairmw.com sales@lairmw.com	
HOLE DIAMETER .35 TO 3.20 3.21 TO 6.35 6.36 TO 12.70 12.71 TO 19.05 19.06 TO 25.40 25.41 TO 50.80		TOLERANCES +.05/-0.2 +.10/-0.3 +.15/-0.3 +.20/-0.3 +.25/-0.3 +.30/-0.3		DRWN ENG CHK Q.A.		波导耦合器 WAVEGUIDE COUPLER	
				SIZE A3		CAGE NO	
				SCALE 3:2		DWG NO.	
				UNIT mm		REV 1	
				SHEET 1 OF 1			